

ARAB HEALTH 2021
USA Partnership Pavilion | Booth Capacity Information
Exhibitor Communications #4



Stand Type: «OrdType»
 Company Name: «Exh_As»
 Booth Number: «ExhibBooth» **subject to change at organizers discretion*

Dear «BthFirst»,

Stand Capacity Regulations

In compliance with the DWTC regulations, **the maximum number of people permitted on a stand (including booth staff, visitors AND furniture/product display) should correspond to 1 person per 4sqm at any one point.** You must adhere to the local physical distancing requirements. On-stand physical distancing must not supersede guidance set out below. As organizer of the USA Partnership Pavilion we will be calculating your capacity and will post that on each stand to be clearly visible per the venue rules.

	9m ²	18m ²	27m ²	36m ²	45m ²	54m ²	72m ²	90m ²	108m ²	120m ²	150m ²	180m ²	225m ²	377m ²	412m ²	494m ²	584m ²
10%	2	4	6	8	10	12	16	20	24	27	34	41	51	85	93	111	131
20%	2	4	5	7	9	11	14	18	22	24	30	36	45	75	82	99	117
30%	2	3	5	6	8	9	13	16	19	21	26	32	39	66	72	86	102
40%	2	3	4	5	7	8	11	14	16	18	23	27	34	57	62	74	88
50%	2	2	3	5	6	7	9	11	14	15	19	23	28	47	52	62	73

For further guidance on the exact number of people per stand size, please email the Technical team; techarabhealth@informa.com or [Read More](#) on page 5.

An example of how this applies to your stand:

Total booth: 12sqm

Total furniture: 2.5sqm

12sqm – 2.5sqm = 8.5

8.5 ÷ 4 = 2.125 or 2 people allowed on the stand.

The below diagram shows a standard 12sqm booth with the standard 12sqm furniture package (1- table, 2- chairs, 1 counter, and 1 waste basket). When the furniture is all placed to one side of the booth, show in diagram B, the remaining available space would be 9sqm. The 9sqm space will accommodate 2 people: including attendees.

A.

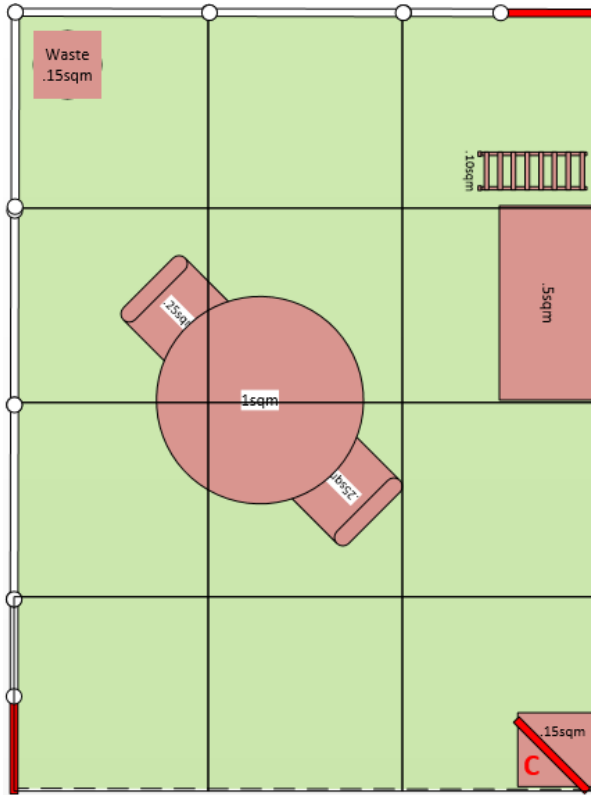

B.

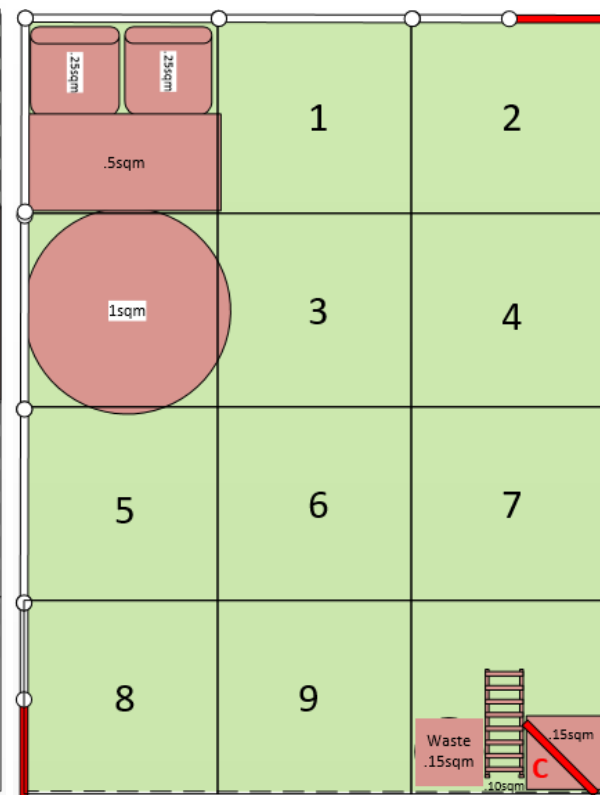

We hope you find this information helpful. If you have any questions or concerns, please do not hesitate to contact us.

Best Regards,
The Kallman Worldwide Arab Health Team

For questions regarding:
Stand design/ booth upgrades/exhibitor passes/ registration
Keira Small | +1 201-251-2600 x189 | KeiraS@kallman.com

Exhibitor Services
Courtney Serpico | +1-201-251-2600 x143 | CourtneyS@kallman.com

Custom Booth Design
Ann Kallman | +1 201-251-2600 x113 | AnnK@kallman.com

Sales
Jodi Munzer | +1 201-251-2600 x119 | JodiM@kallman.com

Sponsorship/ Advertising/ U.S. Guide/ Co-Exhibitor

Gabrielle Fasolo | +1 201-251-2600 x187 | GabrielleF@kallman.com

Kallman Worldwide | 4 North Street, Ste 800 | Waldwick NJ 07463 USA

Learn More. Sell More. Don't Miss a Beat.

The USA Partnership Pavilion is organized by



Join the #USPavilion conversation